

TM1050 50Ω 10W DC~52GHz
2.4mm High Performance 50Ohm Stainless Steel Terminator



Ver A/0 Release Date March, 2018

P/N:TM1050

Features

- DC~52GHz Frequency Range
- Max Power 11W
- VSWR < 1.45 < 1.30 < 1.20 < 1.14
C-Class B-Class A-Class S-Class

Applications

- Miniature Size
- 2.4mm Interfaces
- Wireless
- Radar System
- Commercial and Military
- Test and Measurement
- Communication
- Satcom

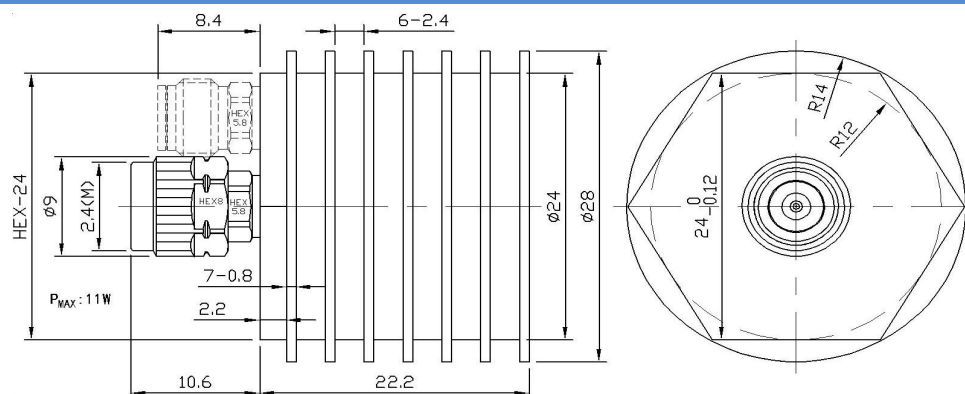

Mechanical & Environmental Specifications

Outer Conductor Coupling Nut	Passivated Stainless Steel	Temp. Range	Storage	-55°C~125°C
Body	Black Anodized Aluminum Heatsink	Working Temp.		-55°C~100°C
Inner Conductor Male	Beryllium Copper Gold plated($\geq 1.27\mu m$)	Altitude	Storage	< 15300 Meters
Female	Beryllium Copper Gold plated($\geq 1.27\mu m$)	Working Temp.		< 4800 Meters
Weight	35 g			

Electrical Specifications

Model	Frequency Range(GHz)	VSWR(:1)	Return Loss(dB)
TM1050-C	DC~50GHz	< 1.45	-14.7
TM1050-B	DC~50GHz	< 1.30	-17.7
TM1050-A	DC~50GHz	< 1.20	-20.8
TM1050-S	DC~50GHz	< 1.14	-23.7

C,B,A,S are performance level. Max frequency is 52.5GHz. Average power: Max power 10W corresponding ambient temp. is 25°C. Power derates linearly to 1W when temperature is up to 100°C. Peak power: Max power 100W (Maximum 5 μs pulse, maximum 4% duty cycle) Working time: no air cooling, ≤ 5 minutes; Reused after cooling to below 30 °C with air cooling, air volume ≥ 5 CFM, long-term work

Remark: a. dimension mm, tol. $\pm 1\%$. b. 100% test. c. Customized according to customer requestments