

TM2040 50Ω 20W DC~42GHz
2.92mm High Performance 50Ohm Stainless Steel Terminator



Ver A/0 Release Date March, 2018

P/N:TM2040

Features

- DC~42GHz Frequency Range
- Max Power 20W
- VSWR < 1.38 < 1.26 < 1.18 < 1.12
C-Class B-Class A-Class S-Class

Applications

- Miniature Size
- 2.92mm Interfaces
- Wireless
- Radar System
- Commercial and Military
- Test and Measurement
- Communication
- Satcom

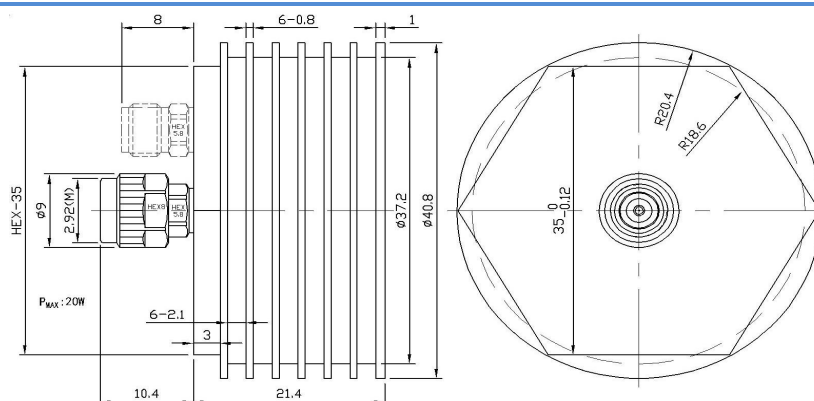

Mechanical & Environmental Specifications

Outer Conductor Coupling Nut	Passivated Stainless Steel	Temp. Range	Storage	-55℃~125℃
Radiator	Black Anodized Aluminum Heatsink		Working Temp.	-55℃~100℃
Inner Conductor Male	Beryllium Copper Gold plated(≥ 1.27μ m)	Altitude	Storage	< 15300 Meters
Female	Beryllium Copper Gold plated(≥ 1.27μ m)		Working Temp.	< 4800 Meters
Weight	68 g			

Electrical Specifications

Model	Frequency Range(GHz)	VSWR(:1)	Return Loss(dB)
TM2040-C	DC~40GHz	< 1.38	-15.9
TM2040-B	DC~40GHz	< 1.26	-18.8
TM2040-A	DC~40GHz	< 1.18	-21.7
TM2040-S	DC~40GHz	< 1.12	-24.9

C,B,A,S are average power of performance level.Average power: Max power 20W corresponding ambient temperature is 25℃ ,Power derates linearly to 2W.When temperature is up to 100℃.Peak power: Max power 200W (Maximum 5 μ s pulse, maximum 5% duty cycle)
 Working time: no air cooling, ≤ 8 minutes; with air cooling, air volume ≥ 10CFM, long-term work