

产品特点

- DC~27GHz 使用频率范围
- 低驻波比

应用场景

- 通用测试
- 精密工作台测量
- 测试端口
- 组件定制

产品规格

- 特殊阻抗: 50ohm
- 工作频率: DC~27GHz
- 耐用性: 500 次
- 温度范围: -55℃~+165℃

材料/表面处理

- 主体: 不锈钢SU303
- 中心导体: 铍青铜
- 绝缘体: PEI&PTFE
- 抛光钝化
- 镀金(MIL-G-45204)

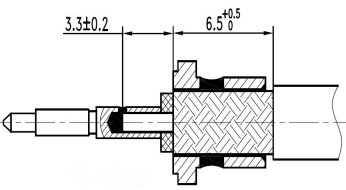
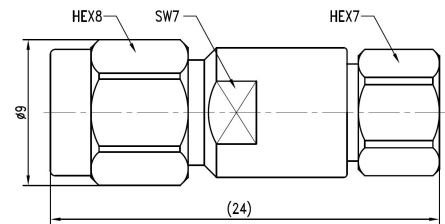

| | |
|-----|------------------------|
| 描述: | SMA 公头接3507线缆, 装接式 |
| PN: | 360CC002701 |
| 驻波: | DC-18GHz...1.25:1(max) |

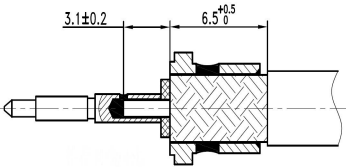
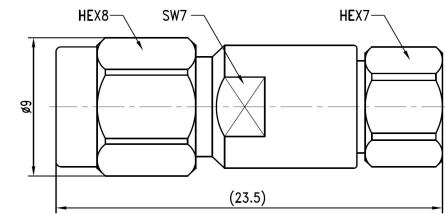

| | |
|-----|------------------------|
| 描述: | SMA 公头接SS402线缆, 装接式 |
| PN: | 400CC002701 |
| 驻波: | DC-18GHz...1.25:1(max) |

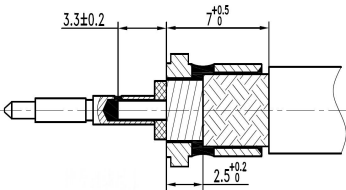
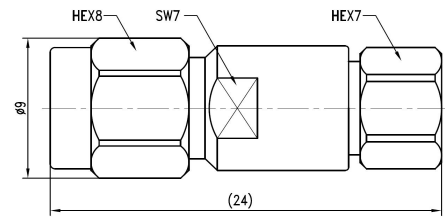

| | |
|-----|------------------------|
| 描述: | SMA 公头接SFT142线缆, 装接式 |
| PN: | 460CC002701 |
| 驻波: | DC-18GHz...1.25:1(max) |

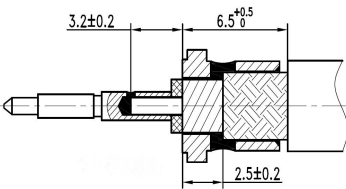
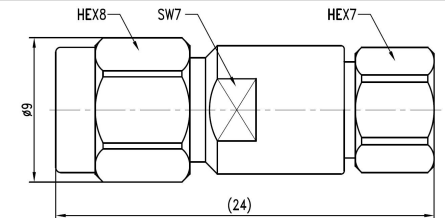

| | |
|-----|------------------------|
| 描述: | SMA 公头接SFT142线缆, 装接式 |
| PN: | 480CC002701 |
| 驻波: | DC-18GHz...1.25:1(max) |

备注:

- 1、所有物理尺寸单位 mm, 尺寸公差±1%。
- 2、网络分析仪在整个频段内进行测试, 100%电性能测试。
- 3、可按照客户要求订制特殊连接器和特殊衰减量。

SMA 50Ω DC~27GHz
SMA High Performance 50ohm Connector For Cable



Ver A/0 Release Date March, 2019 P/N:CC0027

Features

- DC~27GHz Frequency Range
- Low VSWR

Applications

- General purpose test
- Precise Bench-top Testing
- Vector Network Analyzer Test Port
- Custom Cable Assembly

Specifications

- Impedance: 50ohm
- Frequency: DC~27GHz
- Durability: 500 cycles
- Temp. Range: -55°C~+165°C

Material/Finishing

- Housing: Stainless Steel SU303
- Center contact: Beryllium Copper
- Insulators: PEI&PTFE
- Polished/Passivated
- Gold plated (MIL-G-45204)

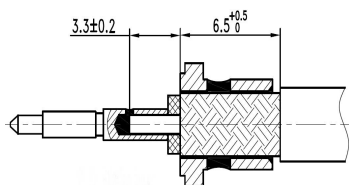
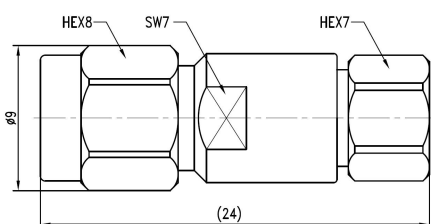

| | |
|--------------|---------------------------|
| Description: | SMA male for 3507 cable |
| PN: | 360CC002701 |
| VSWR: | DC-18GHz ... 1.25:1 (max) |

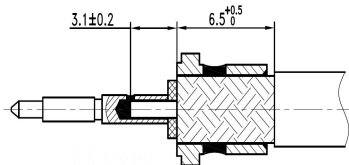
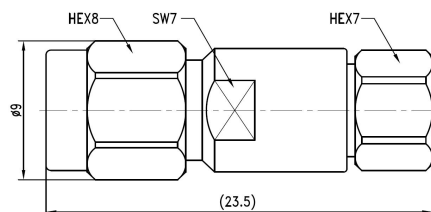

| | |
|--------------|---------------------------|
| Description: | SMA male for S402 cable |
| PN: | 400CC002701 |
| VSWR: | DC-18GHz ... 1.25:1 (max) |

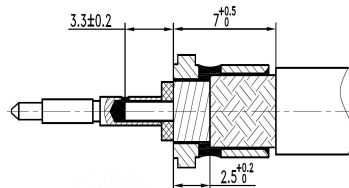
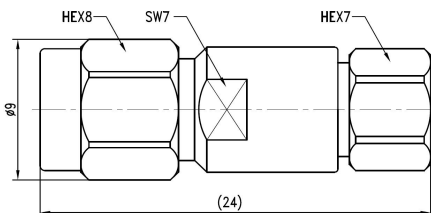

| | |
|--------------|---------------------------|
| Description: | SMA male for SFT142 cable |
| PN: | 460CC002701 |
| VSWR: | DC-18GHz ... 1.25:1 (max) |

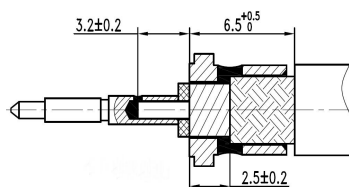
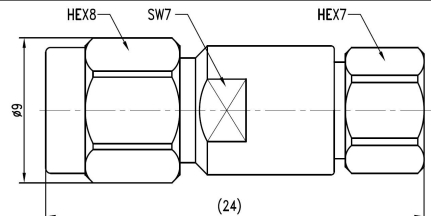

| | |
|--------------|---------------------------|
| Description: | SMA male for SFT142 cable |
| PN: | 480CC002701 |
| VSWR: | DC-18GHz ... 1.25:1 (max) |

Remark

- 1、 All physical dimensions are in mm and the tolerance is $\pm 1\%$
- 2、 The network analyzer tests in the whole frequency band, 100% electrical performance test.
- 3、 Special connectors and special attenuation can be customized according to customer requirements

Shenzhen RFcoms Technology Co.,LTD

Website: www.rfcoms.com

Tell: +86 13480725660

Email: luke@rfcoms.com

The rights of technical information provided on this sheet belongs to RFcoms. Contents cannot be distributed to other third-party companies without permission. The specifications are subjected to change without prior notice